

MINNIE FAMILY

# Minnie *Time*



WINNEBAGO

WINNEBAGO



HELLO  
my name is  
**Minnie Drop**

"Hi, I'm Minnie Drop, six feet four inches wide, single axle, with an eight foot tire stance making me easy to tow. I'm stable and you can see around me with your tow vehicle's side mirrors. My retro figure will turn heads when pulling into the campground, and you can find me in eight fun exciting colors. Each of my six floorplans have dry weights under 3,000 lbs. If it's adventure you're after I'm ready to travel, hitch me up!"



HELLO  
my name is  
**Micro Minnie**

"Who knew fun could be found in a small camper? Seven feet wide, eight open floorplans, and full featured; but my allure doesn't stop there. While most of my models include double door refrigerator, stainless steel sink, three burner range with oven, the 1700BH and 1705RD are single axle models offering a more affordable selection. Please look over the specification page for all the details."



HELLO  
my name is  
**Minnie**

"Minnie does not describe the space and features I bring to the campground. Each of my models include extendable slide outs that increase living space. My traditional eight-foot wide frame allows for an abundance of storage and livability. Open the entry door to seven different floorplans and show off my all new front cap!"

## Each Winnebago Minnie is expertly manufactured with these key features:



BAL Engineered Chassis designed with industry leading strength to weight ratio, rust protection, and durability. Non-welded chassis secured with automotive huck bolts.



Exterior grade tongue and groove plywood flooring securely fastened to aluminum floor supports provide for a superior foundation for cabinets and furniture.



Welded aluminum tube sidewall construction with solid material inserts in areas where screws will be added to hold attachments.



Our T60 high gloss exterior fiberglass side walls are manufactured with the supporting underlayment imbedded to the resin for a superior bond. This is the same process we use on our prestigious motor homes.



HELLO  
my name is  
**Minnie PLUS**

"Looking for a camping partner with more? Look at Minnie Plus. My plus size offers more slide outs, bigger floorplans and more features. Prepare a meal on my solid surface counter top, or relax in my sleeper sofa and you'll be happy to be home away from home. My six unique floorplans along with an overwhelming list of standard features will make your next camping trip a breeze."



HELLO  
my name is  
**Minnie PLUS**  
FIFTH WHEEL

"I want to be the fifth-wheel of your dreams! My spacious elevated stateroom feature's a residential sized queen bed, plenty of storage, and easy access to a luxurious master bath. Attention was paid to maximize my living area and be light enough to be pulled by most half ton trucks. I'm comfortable with my bold colors and my full fiberglass front cap will announce my arrival. If you like open, unique floor plans, and with storage like mine, you'll never want to go home."

## And all are available in these great colors!



Champagne

Orange

Blue

Hunter

Cherry

White

Yellow

Platinum

*\* Photos are of Minnie 2200SS*



**HELLO**

my name is

***Minnie Drop***



\*Photos are of the Minnie Drop 1790  
with exterior Wood Grain Graphics



*My dinette converts to a bed*



*...and additional sleeping space  
is just around the corner*

# FLOORPLANS

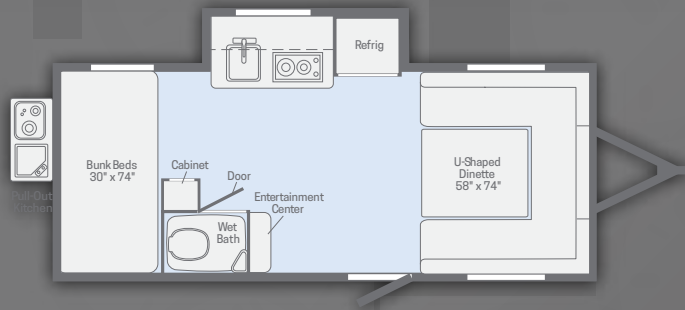

**170K**

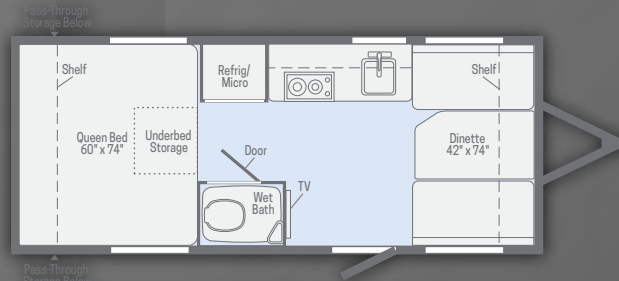

**1710**

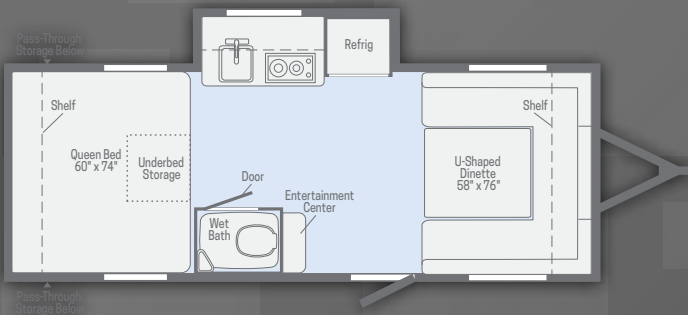

**1780**



**170S**

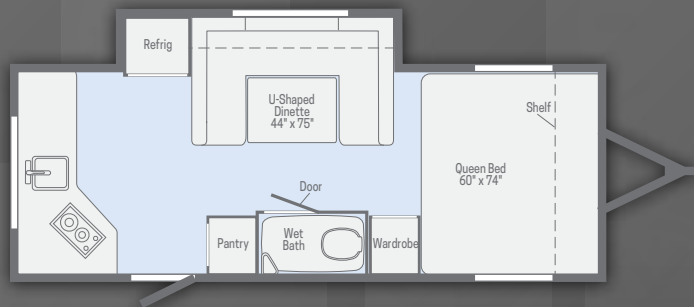

**1790**

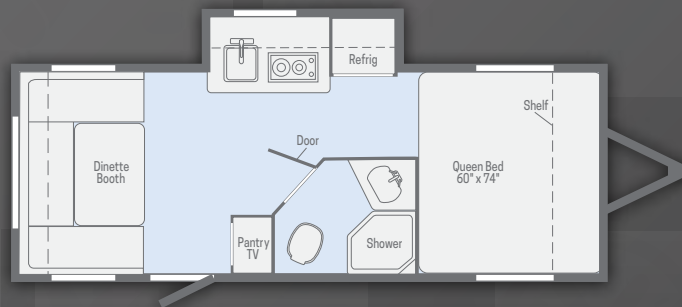

**190RD**

## STANDARD FEATURES

- NXG Engineered Chassis
- T60 Exterior Fiberglass Sidewalls
- One Piece Fiberglass Roof
- 13.5k BTU Roof Air
- Convection Microwave
- AV System AM/FM/CD/DVD/USB/Bluetooth
- USB Charging Ports
- Gas Electric Refrigerator
- 6 Gallon Gas/Electric/DSI Water Heater
- TV Antenna with Booster
- Exterior Speakers
- Aluminum Wheel Assemblies
- Power Awning with LED Lighting\*
- Solar Charger Prep
- 19" TV\*
- Power Tongue Jack\*

## OPTIONS

- Wood Grain Graphics
- 15" Offroad Tire/Axle

*Did you know...*

the first Winnebago  
Travel Trailer was  
built in 1958?

**WINNEBAGO**  
www.winnebagoind.com

\* New standard feature on production after 9/1/17

**HELLO**

my name is

**Micro Minnie**



\*Photos are of Micro Minnie 2106FBS



*lots of storage,  
even in the bathroom*



*...and cross ventilation  
to feel the breeze*



# FLOORPLANS

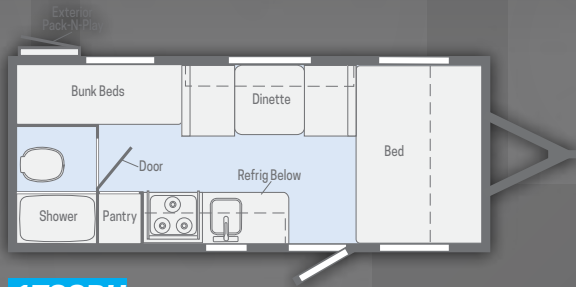

**1700BH**

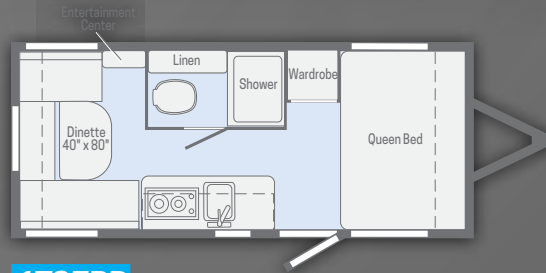

**1705RD**



**1706FB**

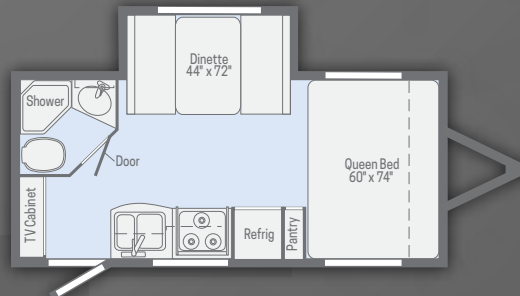

**1808FBS**

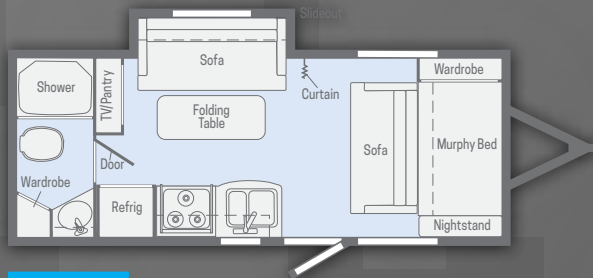

**2106DS**

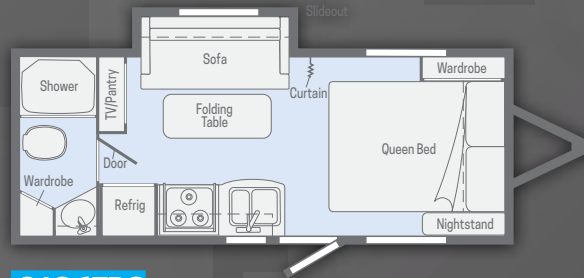

**2106FBS**

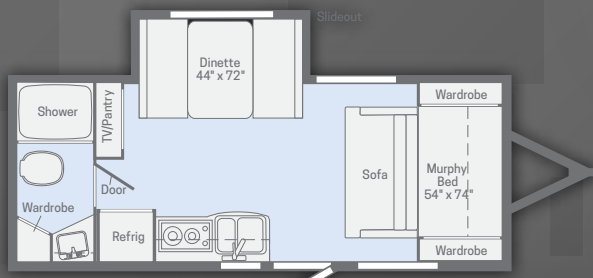

**2108DS**

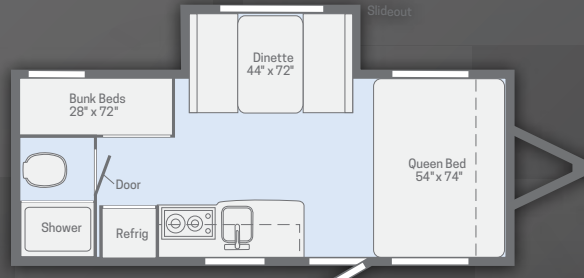

**2100BH**

## STANDARD FEATURES

- NXG Engineered Chassis
- T60 Exterior Fiberglass Sidewalls
- TPO Roof
- 13.5K BTU Roof Air
- Microwave
- AV System AM/FM/CD/DVD/USB/Bluetooth
- USB Charging Ports
- Gas Electric Refrigerator
- 6 Gallon Gas/Electric/DSI Water Heater
- TV Antenna with Booster
- LED TV
- Exterior Speakers
- Aluminum Wheel Assemblies
- Enclosed Tanks
- Power Awning with LED Lighting
- Solar Charger Prep
- Power Tongue Jack

## OPTIONS

- 15.0 BTU A/C - Upgrade

*Did you know...*

in the 1970s  
Winnebago built  
8 heli-homes—  
helicopters with  
lower living spaces?

**HELLO**  
my name is

**Minnie**



\*Photos are Minnie 2200SS



*full shower surround*



*...and a bed that opens to reveal storage*



# FLOORPLANS

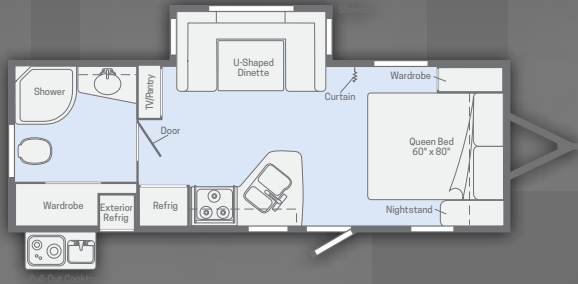

**2201DS**

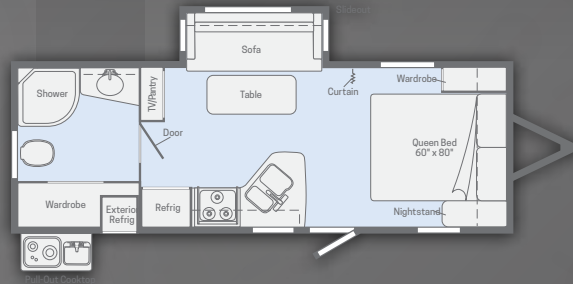

**2200SS**

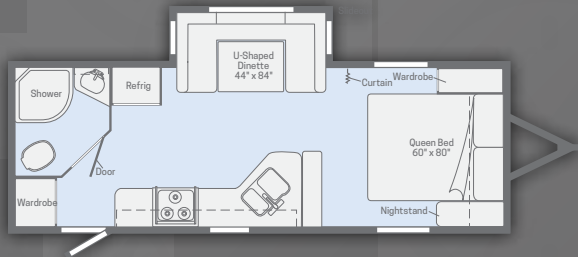

**2250DS**

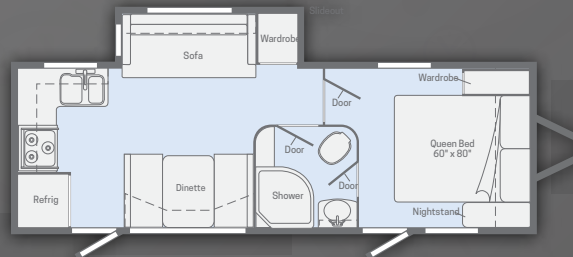

**2401RG**

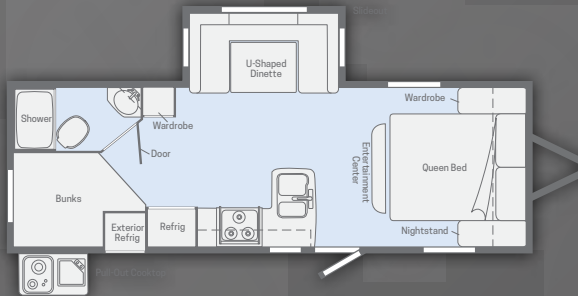

**2455BHS**

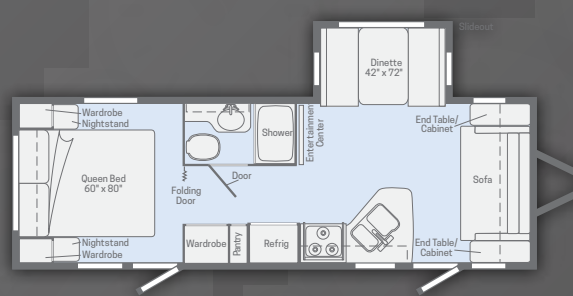

**2500FL**



**2500RL**

## STANDARD FEATURES

- NXG Engineered Chassis
- T60 Exterior Fiberglass Sidewalls
- TPO Roof
- Fiberglass Front Cap
- 13.5K BTU Roof Air
- Microwave
- Three Burner Range with Oven
- AV System AM/FM/CD/DVD/USB/Bluetooth
- USB Charging Ports
- Double Door Gas Electric Refrigerator
- 6 Gallon Gas/Electric/DSI Water Heater
- TV Antenna with Booster
- LED TV
- Exterior Speakers
- Aluminum Wheel Assemblies
- Enclosed Tanks
- Power Awning with LED Lighting
- Solar Charger Prep
- Power Tongue Jack

## OPTIONS

- 30# LP Tank Option Upgrade
- 15.0K BTU Roof Air
- 19" LED Bedroom TV w/ Flip Down Bracket (2401RG, 2455BHS, 2500FL, 2500RL only)

*Did you know...*

every Winnebago travel trailer is built in Middlebury, Indiana?

HELLO  
my name is  
**Minnie PLUS**



*Optional theatre seating*



*...and a spacious galley*

\*Photos are Minnie Plus 30RLSS

# FLOORPLANS

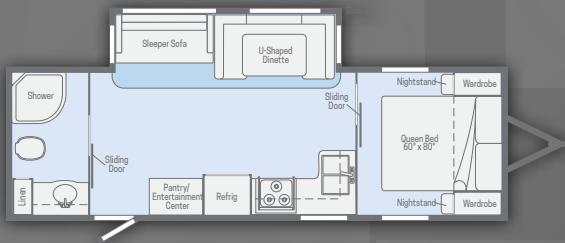

**26RBSS**

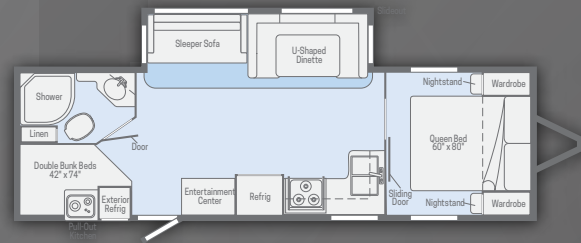

**27BHSS**

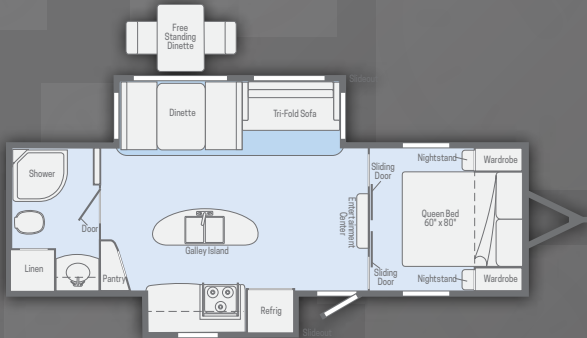

**27RBDS**

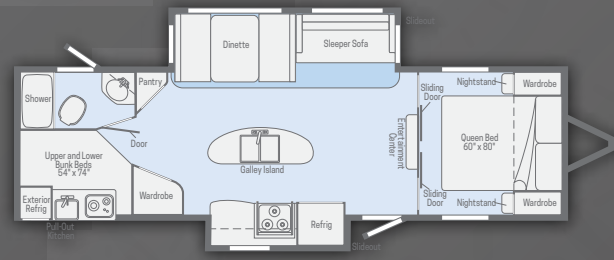

**29DDBH**

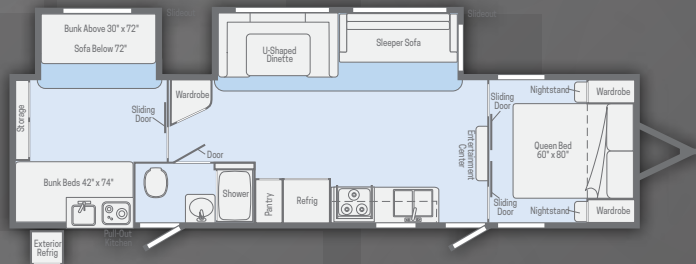

**31BHDS**



**30RLSS**

## STANDARD FEATURES

- NXG Engineered Chassis
- T60 Exterior Fiberglass Sidewalls
- TPO Roof
- Painted Fiberglass Front Cap
- 15.0K BTU Roof Air
- Microwave
- Flush Mount Three Burner Range with Oven
- Solid Surface Counter Top
- Stainless Steel Galley Sink
- AV System AM/FM/CD/DVD/USB/Bluetooth
- USB Charging Ports
- Large Double Door Gas Electric Refrigerator
- 10 Gallon Gas/Electric/DSI Water Heater
- TV Antenna with Booster
- LED TV
- Exterior Speakers
- Aluminum Wheel Assemblies
- Enclosed Tanks
- Power Awning with LED Lighting
- Power Stabilizing Jacks
- Solar Charger Prep

## OPTIONS

- Secondary Awning (31BHDS only)
- Dual Pane Windows
- 15.0K BTU 2nd Roof Air (30RLSS, 31BHDS ONLY) 60A (424) REQ'D
- Fireplace with Remote
- 50 Amp Service w/ 2nd A/C Prep (30RLSS & 31BHDS only)
- Theater Seating IPO Recliners (30RLSS only)
- Swivel/Rocker/Recliners IPO Sleeper Sofa (N/A 30RLSS)
- Free Standing Table w/ 4 Chairs
- 32" LED TV Rear Bunk (31BHDS only)
- Extreme Weather Package



**HELLO**

my name is

**Minnie PLUS**  
FIFTH WHEEL



\*Photos are Minnie Plus Fifth Wheel 25RKS



*custom cabinets & solid  
surface counter tops...*



*and dual entry private  
bathrooms in every floorplan*

# FLOORPLANS



**25RKS**



**27REOK**

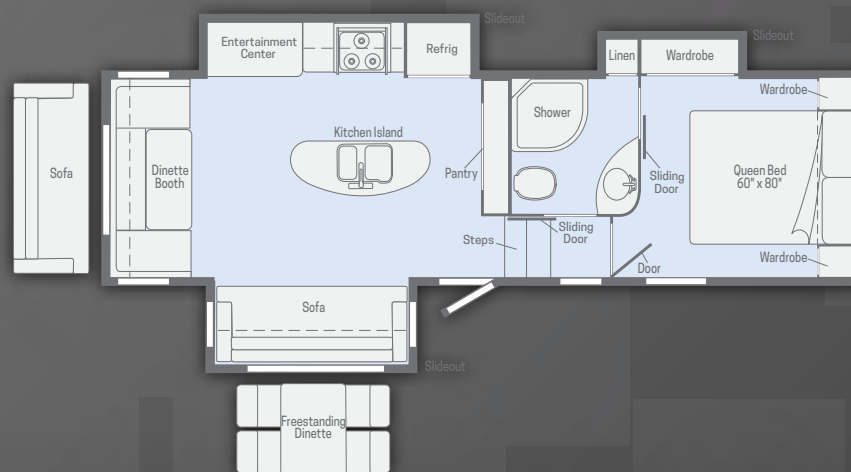

**27RLTS**

## STANDARD FEATURES

- NXG Engineered Chassis
- T60 Exterior Fiberglass Sidewalls
- TPO Roof
- Painted Fiberglass Front Cap
- 15.0K BTU Roof Air
- Microwave
- Flush Mount Three Burner Range with Oven
- Solid Surface Counter Top
- Stainless Steel Galley Sink
- AV System AM/FM/CD/DVD/USB/Bluetooth
- USB Charging Ports
- Large Double Door Gas Electric Refrigerator
- 10 Gallon Gas/Electric/DSI Water Heater
- TV Antenna with Booster
- LED TV
- Exterior Speakers
- Aluminum Wheel Assemblies
- Enclosed Tanks
- Power Awning with LED Lighting
- Power Stabilizing Jacks
- Solar Charger Prep

## OPTIONS

- Dual Pane Windows
- 15.0K BTU 2nd Roof Air, non-ducted
- Fireplace with Remote (27RLTS, 27REOK Only)
- Swivel/Rocker/Recliners IPO Sleeper Sofa
- Two Freestanding Chairs (Available on all models)
- Freestanding table & 4 chairs (Available on all models)
- 31" LED TV Bedroom TV
- Extreme Weather Package









Norman & Janet Schultz



Ryan Blondo



Tim & Julie Morrison



Edward Blaser

# Where do you want to go?



Ken & Pam Smith



David Robinson

**PREFERRED CARE PROGRAM**

We back our towable products with best-in-class support.

- Complimentary 24-hour roadside assistance program
- Flat Tire Changes
- Towing
- Mobile Mechanic
- RV Technical Support
- Lock-out Service
- Fuel Delivery
- Jump-Starts
- Service Appointment
- Tow Vehicle Covered When Towing

Premium ROADSIDE ASSISTANCE



[www.witclub.com](http://www.witclub.com)



Have a question about the Minnie Family?  
Email [SalesW01@WGO.net](mailto:SalesW01@WGO.net).

## WINNEBAGO

**Winnebago of Indiana**  
201 14th Street, P.O. Box 2001  
Middlebury, IN 46540 (574) 825-5250  
[www.winnebagoind.com](http://www.winnebagoind.com)

Your Winnebago Dealer

Winnebago Industries® continuing program of product improvement makes specifications, equipment, model availability, and prices subject to change without notice. Published content reflects the most current product information at time of printing. 2017 Winnebago of Indiana, LLC 0817v1

